

### LEGEND

ROADS AND ROADWAY FEATURES		NAVIGATION	
UNIMPROVED ROAD	---	DOCK, PIER OR LANDING	---
GRAVEL ROAD	---	LENS OR DUNE	---
PAVED ROAD	==	LEVEL OR ONE WITH ROAD	---
UNIMPROVED HIGHWAY	---	CITY AND VILLAGE CENTERS	
DIVIDED HIGHWAY	---	COUNTY SEAT	○
INTERSTATE SYSTEM	---	OTHER CITIES AND VILLAGES	○
CITY STREETS	---	MISCELLANEOUS	
HIGHWAY BRIDGES		TRIANGULATION STATION	△
BRIDGE 50 FEET AND OVER	---	BENCH MARK WITH ELEVATION	○
DRYWATER	---	PUBLIC SERVICE FACILITIES	
DRYWATER	---	OBSERVATION OR LOOKOUT TOWER	○
DRYWATER	---	HIGHWAY GARAGE	○
DRYWATER	---	POST OFFICE	○
DRYWATER	---	POWER PLANT	○
DRYWATER	---	WEIGHT STATION	○
DRYWATER	---	SEWAGE DISPOSAL PLANT	○
DRYWATER	---	COMMUNITY CENTER OR TOWNHALL	○
DRYWATER	---	NATIONAL PARK GARAGE	○
DRYWATER	---	PUBLIC LIBRARY	○
DRYWATER	---	FIRE STATION	○
DRYWATER	---	SANITARY LAND FILL	○
DRYWATER	---	CORRECTIONAL INSTITUTION	○
DRYWATER	---	POLICE STATION	○
DRYWATER	---	GRAVEL PIT	○
DRYWATER	---	REST AREA	○
DRYWATER	---	CONSERVATION AND RECREATION	
DRYWATER	---	AIRPORT, LIMITED FACILITIES	○
DRYWATER	---	AIRPORT, COMPLETE FACILITIES	○
DRYWATER	---	MOTEL OR HOTEL	○
DRYWATER	---	CAMP OR LODGE	○
DRYWATER	---	HISTORIC OR SCENIC SITE	○
DRYWATER	---	FAIR GROUNDS OR RACE COURSE	○
DRYWATER	---	SMALL PARK	○
DRYWATER	---	GOLF COURSE OR COUNTRY CLUB	○
DRYWATER	---	INDUSTRIAL	
DRYWATER	---	FACTORY OR INDUSTRY	○
DRYWATER	---	SEASONAL INDUSTRY	○
DRYWATER	---	CHURCHES AND CEMETERIES	
DRYWATER	---	CHURCH	○
DRYWATER	---	CEMETERY	○
DRYWATER	---	CHURCH WITH CEMETERY ADJACENT	○
DRYWATER	---	EDUCATION	
DRYWATER	---	SCHOOL	○
DRYWATER	---	MISCELLANEOUS STRUCTURES	
DRYWATER	---	ARMORY	○
DRYWATER	---	FORT, ARMY CAMP	○

A B C D E F

A B C D E F

480 000m 470 000m 460 000m 450 000m

480 000m 470 000m 460 000m 450 000m

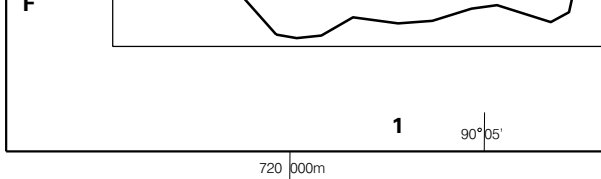
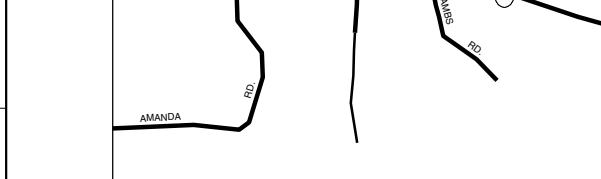
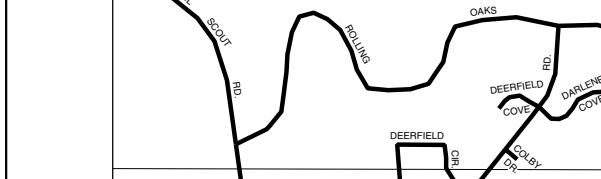
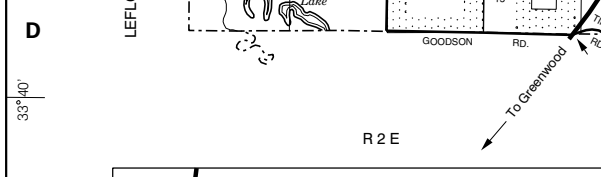
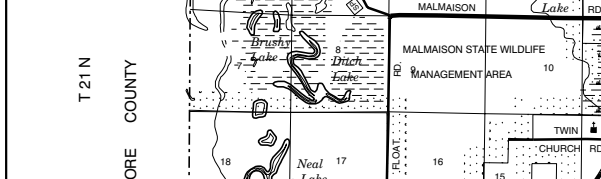
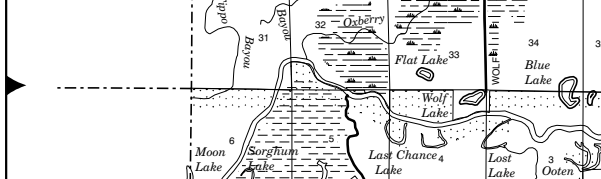
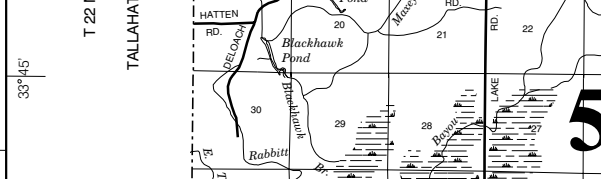
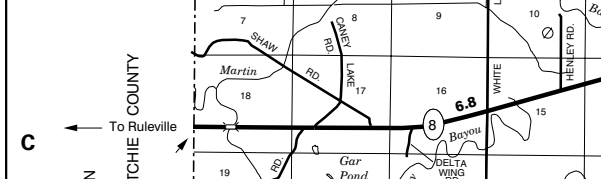
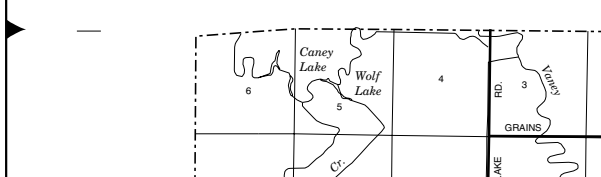
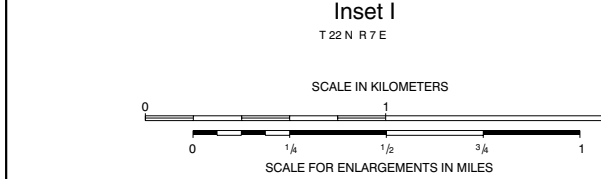
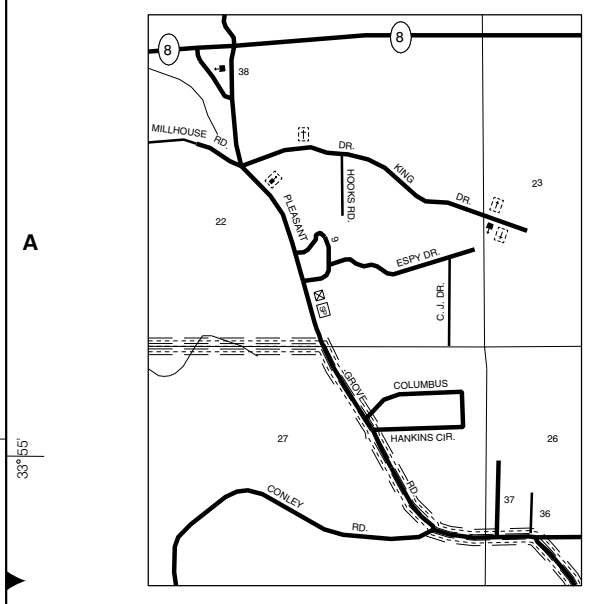
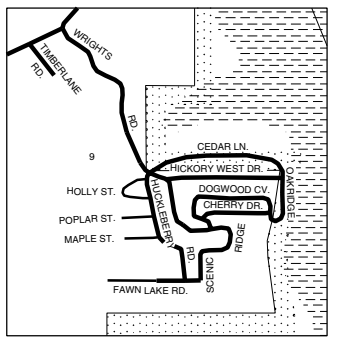
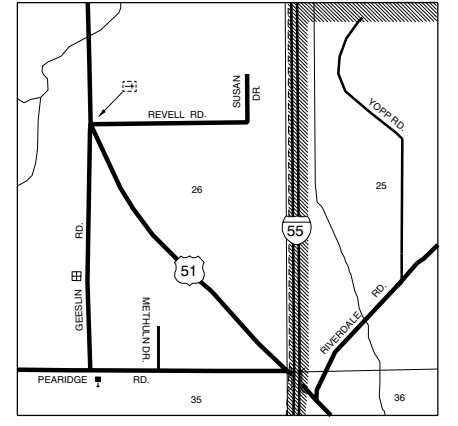
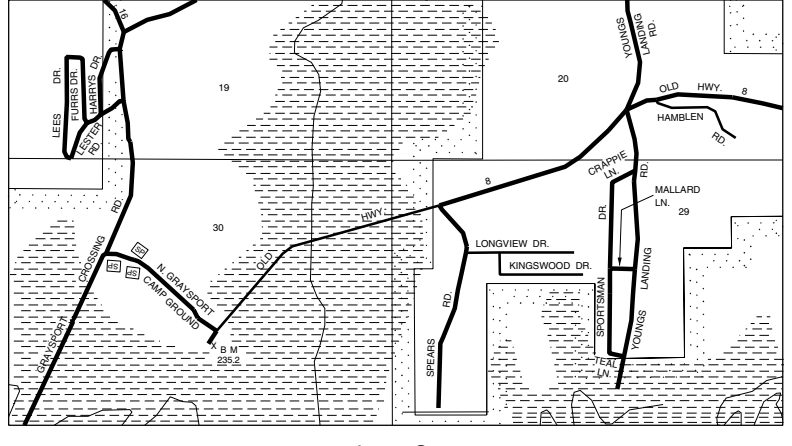

MISSISSIPPI DEPARTMENT OF TRANSPORTATION  
COPYRIGHT LICENSE AGREEMENT

With the purchase of this map, the Mississippi Department of Transportation grants you the right to use the copyrighted map as an individual.

The map is owned by the Mississippi Department of Transportation and is protected by the United States copyright laws and international conventions. You are required to use the map like any other copyrighted material except that you may copy the map in whole or in part without modification, provided the number of copies to the Mississippi Department of Transportation is reported to a government official or official.

You have a copyright free right to reproduce and distribute the copyrighted map in whole or in part, without modification, provided the Mississippi Department of Transportation copyright notice is placed in a prominent visible location on each reproduction. Any modification of a map voids this agreement and makes your name to use, copy, and distribute the map. Use of modified maps is strictly prohibited and is subject to prosecution under State and Federal Laws.

This agreement is governed by the Laws of the State of Mississippi, U.S. Federal Law, and U.S. International Treaties. Should you have any questions concerning this agreement, please write: Mississippi Department of Transportation, Planning Division, P.O. Box 1000, Jackson, Mississippi 39205-1000.

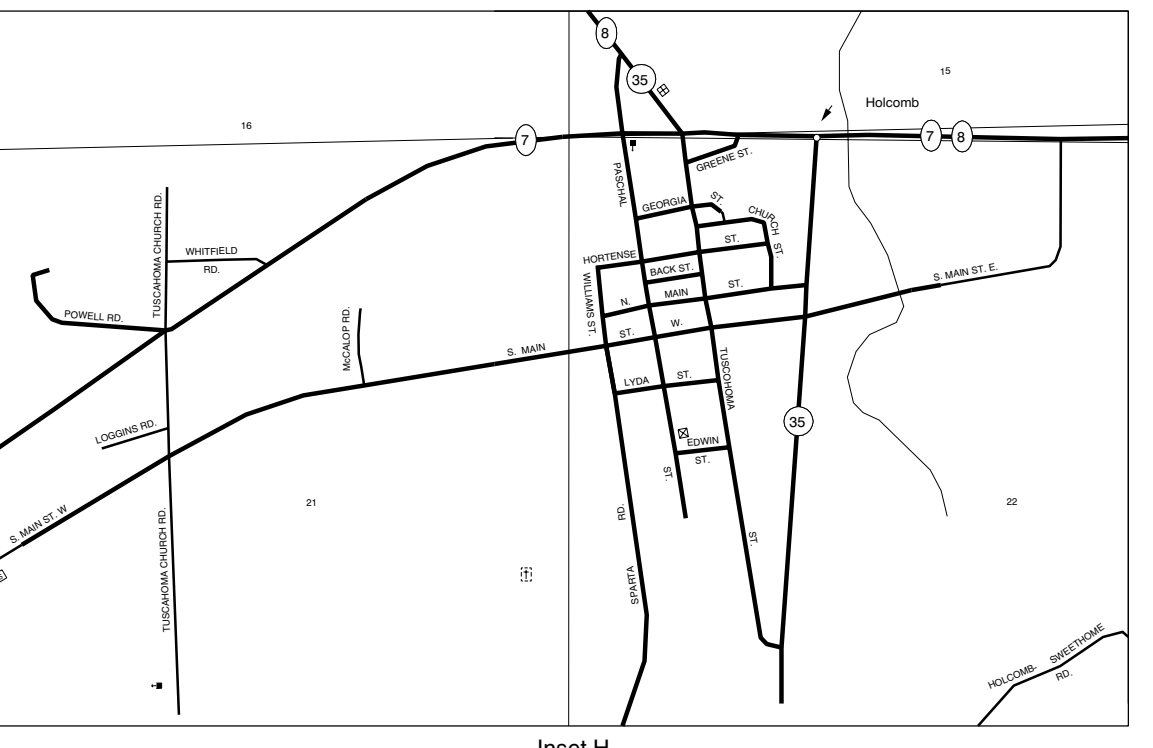
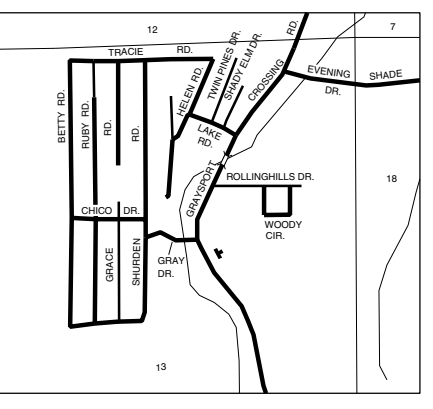

GENERAL HIGHWAY MAP

# GRENADA COUNTY

MISSISSIPPI  
© 2005

MISSISSIPPI DEPARTMENT OF TRANSPORTATION  
PLANNING DIVISION

IN COOPERATION WITH THE  
U.S. DEPARTMENT OF TRANSPORTATION  
FEDERAL HIGHWAY ADMINISTRATION

TRANSVERSE MERCATOR PROJECTION,  
STATE PLANE COORDINATE SYSTEM 1983

**DATA SOURCES**

- 1996 ASCS AERIAL PHOTOS
- 1987 USGS DLG
- 2001 MDOT FIELD INVENTORY
- 2000 POPULATION 23,263
- 2004 BEAT LINES

SCALE IN KILOMETERS  
SCALE IN MILES

THE MAP WAS COMPUTER GENERATED