

GENERAL LEGEND

- HIGHWAY WITH FULL CONTROL OF ACCESS
- HIGHWAY INTERCHANGE
- DIVIDED HIGHWAY
- HARD SURFACED ROAD
- SOIL, GRAVEL OR SHELL SURFACED ROAD
- GRADED AND DRAINED ROAD
- UNIMPROVED ROAD
- PRIMITIVE ROAD
- PRIVATE ROAD
- EXTENSION OF LOCAL ROADS WITHIN CITY LIMITS
- INTERSTATE HIGHWAY
- U.S. NUMBERED HIGHWAY
- STATE HIGHWAY
- COUNTY ROAD
- RAILROAD
- DOUBLE TRACK RAILROAD
- ABANDONED RAILROAD
- RAILROAD STATION
- RAILROAD BELOW
- COMMERCIAL OR MUNICIPAL AIRPORT
- LANDING AREA OR STRIP
- RUNWAYS
- CANAL OR DRAINAGE DITCH
- NARROW STREAM
- WIDE STREAM
- DAM OR SPILLWAY WITH LOCK
- FLOOD CONTROL STRUCTURE
- LAKE, RESERVOIR OR POND
- INTERMITTENT POND
- MEANDERED LAKE
- MARSH OR SWAMP
- LEVEE OR DIKE
- HIGHWAY BRIDGE
- HIGHWAY GRADE SEPARATION
- COUNTY BOUNDARY LINE
- CIVIL TOWNSHIP BOUNDARY
- LAND SECTION LINE
- FOREST OR PARK BOUNDARY
- LOCATION OF INSET BOUNDARY WITHIN MAP
- COUNTY SEAT
- OTHER CITY OR VILLAGE
- CORPORATE LIMITS
- DELIMITED AREA
- RESIDENTIAL AREA UNDER DEVELOPMENT
- WAYSIDE PARK OR SMALL PARK
- PARK WITH BOAT RAMP
- BOAT RAMP
- RECREATIONAL AREA OR HISTORIC SITE
- POST OFFICE
- SCHOOL
- CHURCH
- CEMETERY
- CHURCH AND CEMETERY
- TOLL HOUSE OR WEIGHT STATION
- FAIR GROUNDS, RACE COURSE OR RODEO ARENA
- FIRE CONTROL HEADQUARTERS
- LOOKOUT TOWER
- POWER SUBSTATION
- COMMUNICATIONS FACILITY
- LOOKED GATE OR FENCE
- TRIANGULATION STATION WITH NAME

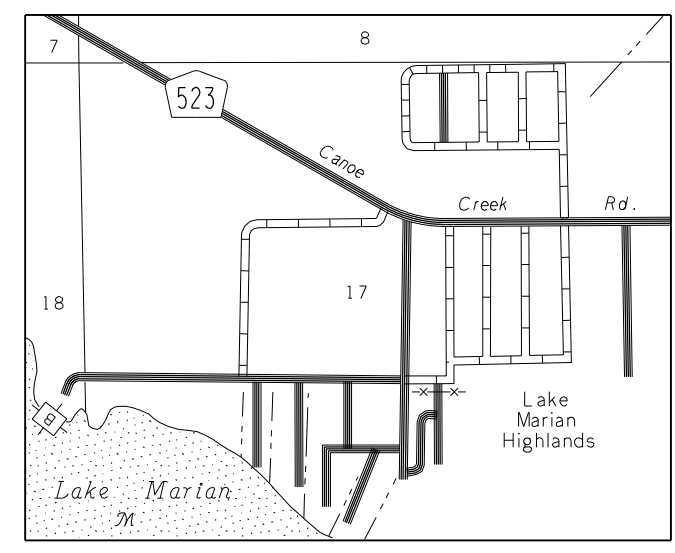

This map was compiled from U.S. Geological Survey maps and maps available to the public in 1997. 2000 General Land Office data, road inventory surveys from 2002, and other map data.

This map was compiled using interactive computer graphic techniques.

This map was prepared on the Transverse Mercator projection, East Zone, NAD83, Florida system of State coordinates.

The railroad station symbol on shown on the map does not necessarily denote the presence of a station or the facility. It may be only a point designated for the receipt or delivery of freight, such as a platform or siding.

Local road alignments in Delimited Areas and Provisional Areas Under Development are not indicated.

In congested rural areas local roads are indicated by a single line only for detail and for use in the county.

No attempt has been made to show all drainage canals and ditches.

City populations are taken from the U.S. Census for 2000.

In 2000, the population of Osceola County was 172,493. There are 1,322 square miles in the county.

No claim is made for the basic cartographic source material taken from a work or works of the United States Government.

Maps of this series are in the public domain. The maps are compiled and published using public law maps and are copyrighted to prevent photocopying and resale for profit.

Permission to copy or reproduce this map must be authorized by the Surveying and Mapping Office, Department of Transportation, Tallahassee, Florida 32399-0450.

GENERAL HIGHWAY MAP
OSCEOLA COUNTY
FLORIDA

PREPARED BY THE
SURVEYING AND MAPPING OFFICE
FOR THE
DIVISION OF TRANSPORTATION PLANNING
STATE OF FLORIDA
DEPARTMENT OF TRANSPORTATION
IN COOPERATION WITH THE
U.S. DEPARTMENT OF TRANSPORTATION
FEDERAL HIGHWAY ADMINISTRATION

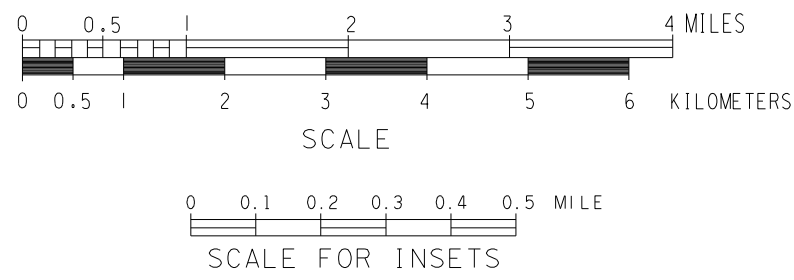

JUNE, 2003

COPYRIGHT FLORIDA DEPARTMENT OF TRANSPORTATION 2003

REVISIONS	
FEATURES	DATE
State Maintained Roads	June, 2003

CITY BOUNDARIES ARE PLOTTED USING ALL AVAILABLE DESCRIPTIONS AT DATE OF REVISION. THE FLORIDA DEPARTMENT OF TRANSPORTATION CANNOT ACCEPT RESPONSIBILITY FOR INACCURACIES RESULTING FROM UNOBTAINABLE OR UNKNOWN DATA.

DUE TO THE SCALE OF THIS MAP THE STATE OF FLORIDA DEPARTMENT OF TRANSPORTATION ASSUMES NO RESPONSIBILITY FOR INACCURACIES IN ROAD ALIGNMENTS, CONFIGURATION OF INTERSECTIONS, AND OTHER RELATED DATA.

FOR PRICE AND AVAILABILITY CONTACT:
FLORIDA DEPARTMENT OF TRANSPORTATION
MAPS AND PUBLICATION
TALLAHASSEE, FL 32399-0450
PHONE: (904) 495-4900