

GENERAL HIGHWAY MAP PUTNAM COUNTY ILLINOIS

PREPARED BY THE
DEPARTMENT OF TRANSPORTATION
OFFICE OF PLANNING AND PROGRAMS
IN COOPERATION WITH THE
U.S. DEPARTMENT OF TRANSPORTATION
FEDERAL HIGHWAY ADMINISTRATION

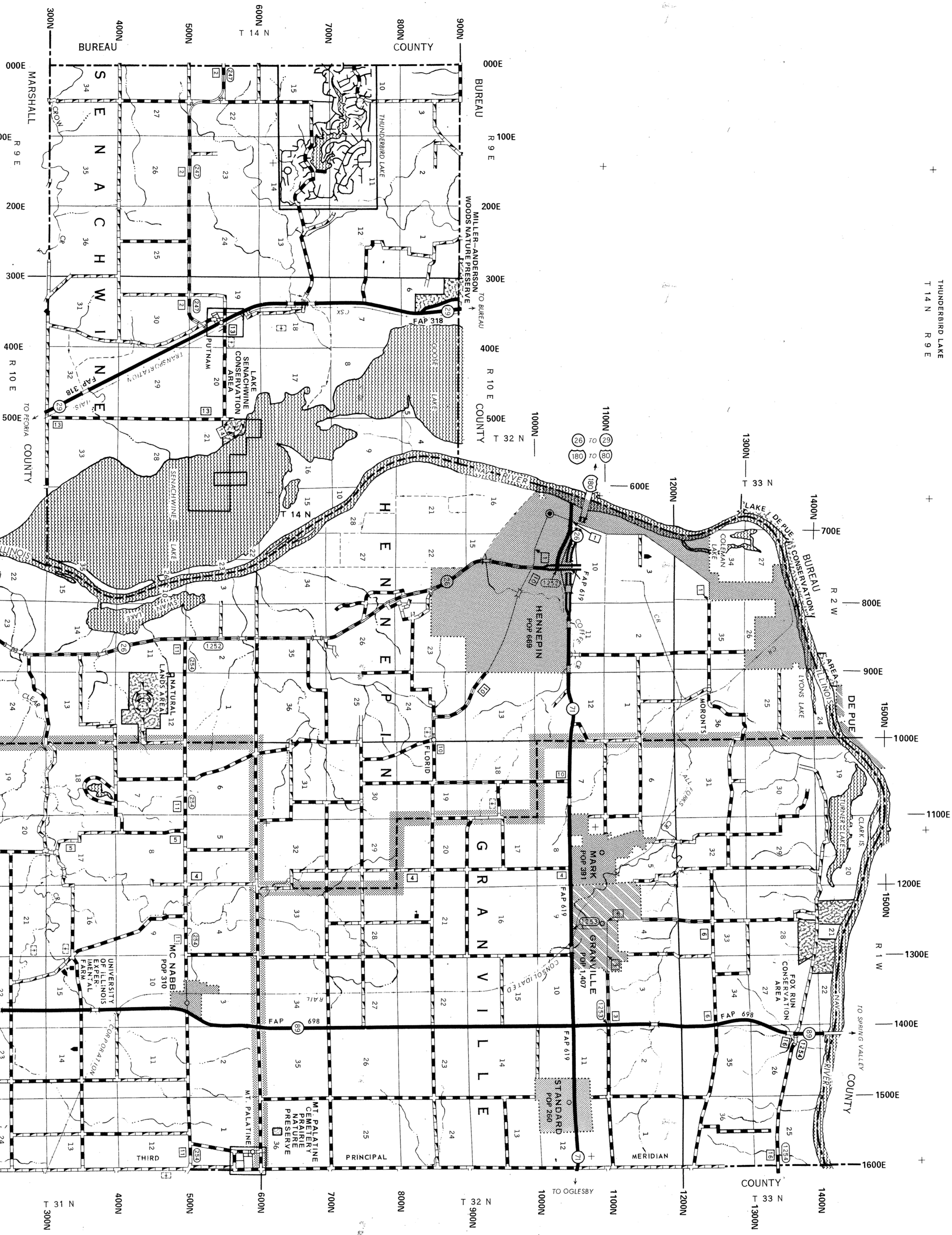

- ### LEGEND
- #### CLASSIFICATION OF ROADS AND STREETS
- MARKED ROUTE - U.S. H.L. AND INTERSTATE
 - HIGHWAY WITH CONTROL OF ACCESS
 - PAVED DIVIDED (CONC. INDICATES ROAD WIDTH)
 - UNDIVIDED
 - BITUMINOUS HIGH TYPE
 - GRAVEL OR STONE
 - SOIL SURFACE
 - UNIMPROVED
 - GRADED AND RANDED
 - FEDERAL-MAINTAINED PRIMARY ROUTE
 - FEDERAL-MAINTAINED SECONDARY ROUTE
 - COUNTY HIGHWAY
- #### CITIES AND VILLAGES
- COUNTY SEAT
 - OTHER
- #### STRUCTURES, NAVIGATION AND DRAINAGE
- HIGHWAY BRIDGE OVER 20 FT. CLEAR SPAN
 - FREE FERRY
 - DAM WITH LOCK
 - DRAINAGE DITCH OR DREDGED STREAM
 - CANAL
- #### BOUNDARY LINES AND SCREENS
- CIVIL TOWNSHIP OR ROAD DISTRICT
 - FOREST PRESERVE OR PARK AREA
 - MILITARY RESERVATION
- #### AIRPORTS
- SCHEDULED SERVICE
 - OTHER
 - SEAPLANE BASE
- #### CULTURAL FEATURES
- SCHOOL
 - HOSPITAL
 - CHURCH
 - PUBLIC BUILDING
 - CEMETERY
 - POWER PLANT
 - CORRECTIONAL INSTITUTION
 - BEST AREA
 - SCENIC SITE
 - STATE HIGHWAY POLICE STATION
 - FIRE GROUND
 - FIRE DEPARTMENT
 - TOLL PLAZA
 - WEIGHT STATION

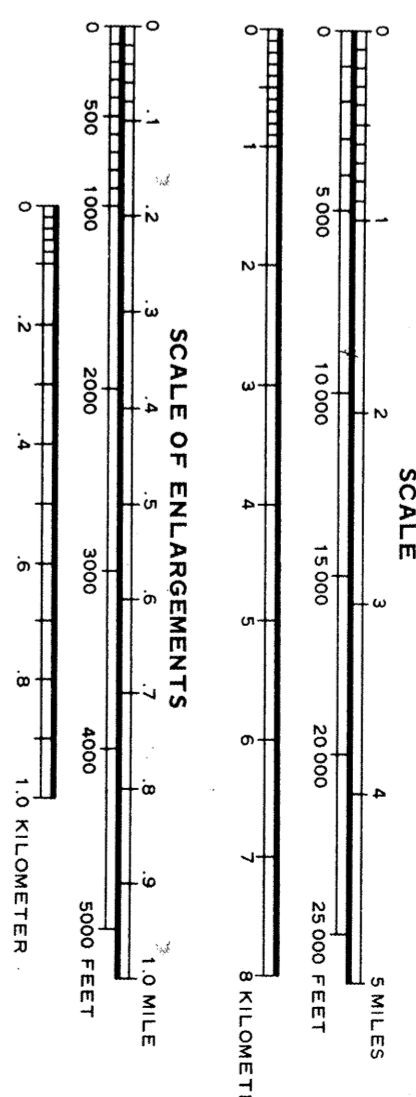
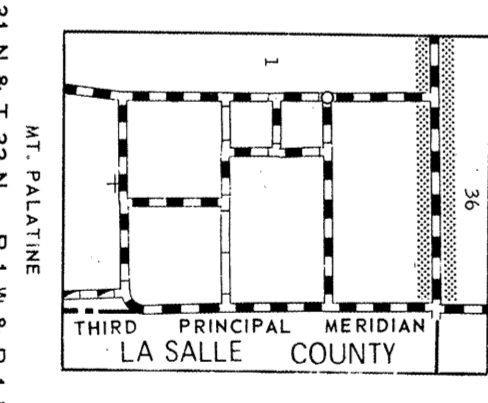
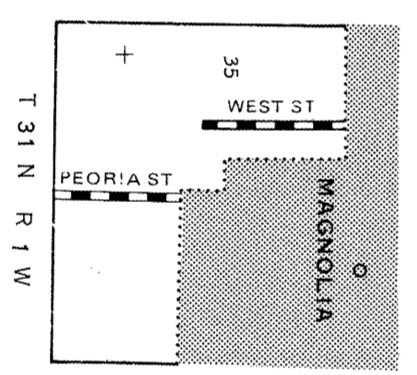
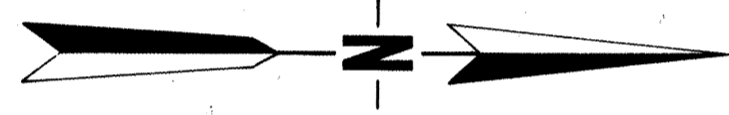
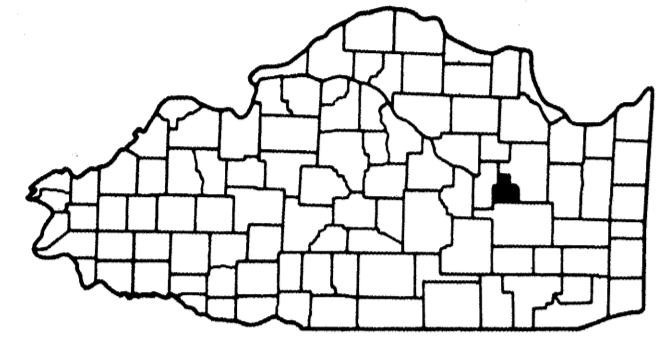

CONTROL: U.S. COAST AND GEODETIC SURVEY; U.S. GEOLOGICAL SURVEY; U.S. PUBLIC LANDS SURVEY; BALDWIN PHOTOGRAPHY; AERIAL PHOTOGRAPHS; AND DIVISION OF HIGHWAYS ROAD INVENTORY.

THE RURAL REFERENCE SYSTEM USES THE SECTION LINE CORNER POINTS TO ESTABLISH THE SECTION LINE AND EAST FROM ITS WESTERNMOST SECTION LINE.

POULSON PROJECTION
ON ILLINOIS
STATE PLANE COORDINATES (WEST ZONE)
POPULATION 5,281,790 (1990)
TOTAL AREA 173,500 SQUARE MILES

ORIGINAL DATA	1986
REVISED DATE	
BY	
DATE	
MAP	12-91-93