

- GENERAL LEGEND**
- HIGHWAY WITH FULL CONTROL OF ACCESS
 - HIGHWAY INTERCHANGE
 - DIVIDED HIGHWAY
 - HARD SURFACED ROAD
 - SOIL, GRAVEL OR SHELL SURFACED ROAD
 - GRADED AND DRAINED ROAD
 - UNIMPROVED ROAD
 - PRIMITIVE ROAD
 - PRIVATE ROAD
 - STREETS IN INSET WITHIN MAP
 - INTERSTATE ROUTE
 - U.S. ROUTE
 - STATE ROUTE
 - COUNTY ROUTE
 - RAILROAD
 - DOUBLE TRACK RAILROAD
 - ABANDONED RAILROAD
 - RAILROAD STATION
 - GRADE CROSSING
 - RAILROAD ABOVE
 - RAILROAD BELOW
 - MILITARY FIELD
 - COMMERCIAL OR MUNICIPAL AIRPORT
 - LANDING AREA OR STRIP
 - RUNWAYS
 - CANAL OR DRAINAGE DITCH
 - INTRACOASTAL WATERWAY
 - NARROW STREAM
 - WIDE STREAM
 - DAM
 - LAKE, RESERVOIR OR POND
 - MARSH OR SWAMP
 - HIGHWAY BRIDGE
 - HIGHWAY GRADE SEPARATION
 - STATE BOUNDARY LINE
 - COUNTY BOUNDARY LINE
 - CIVIL TOWNSHIP BOUNDARY
 - EXTENDED TOWNSHIP LINE
 - LAND GRANT LINE
 - LAND SECTION LINE
 - FOREST OR PARK BOUNDARY
 - MILITARY RESERVATION BOUNDARY
 - LOCATION OF INSET BOUNDARY WITHIN MAP
 - COUNTY SEAT
 - OTHER CITY OR VILLAGE
 - CORPORATE LIMITS
 - DELIMITED AREA, POPULATION EST.
 - WELCOME STATION
 - BOAT RAMP
 - RECREATIONAL AREA OR HISTORIC SITE
 - POST OFFICE
 - SCHOOL
 - CHURCH
 - CEMETERY
 - CHURCH AND CEMETERY
 - TOLL HOUSE OR WEIGHT STATION
 - GAME CHECKING STATION
 - LOOKOUT TOWER
 - FIRE STATION
 - PATROL OR POLICE STATION
 - CORRECTIONAL INSTITUTION OR ROAD CAMP
 - SANITARY FILL
 - POWER PLANT
 - POWER SUBSTATION
 - COMMUNICATIONS FACILITY
 - LOCKED GATE OR FENCE
 - TRIANGULATION STATION WITH NAME
 - LOCATION OF SYMBOL

GENERAL HIGHWAY MAP ESCAMBIA COUNTY FLORIDA

PREPARED BY THE
SURVEYING AND MAPPING OFFICE
FOR THE
DIVISION OF TRANSPORTATION PLANNING
STATE OF FLORIDA
DEPARTMENT OF TRANSPORTATION
IN COOPERATION WITH THE
U.S. DEPARTMENT OF TRANSPORTATION
FEDERAL HIGHWAY ADMINISTRATION

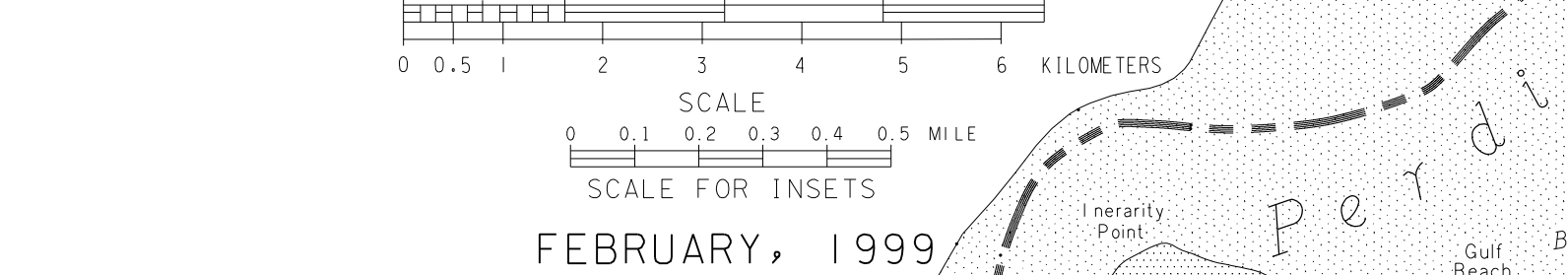

REVISIONS

FEATURES	DATE
State Maintained Roads	February, 1999

KEY

PERDIDO KEY	STATE RECREATION AREA
-------------	-----------------------

CITY BOUNDARIES ARE PLOTTED USING ALL AVAILABLE DESCRIPTIONS AT DATE OF REVISION. THE FLORIDA DEPARTMENT OF TRANSPORTATION CANNOT ACCEPT RESPONSIBILITY FOR INACCURACIES RESULTING FROM UNOBTAINABLE OR UNKNOWN DATA.

FOR PRICE AND AVAILABILITY CONTACT: DEPARTMENT OF TRANSPORTATION TALLAHASSEE, FL 32399-0500 PHONE: (904) 414-4000

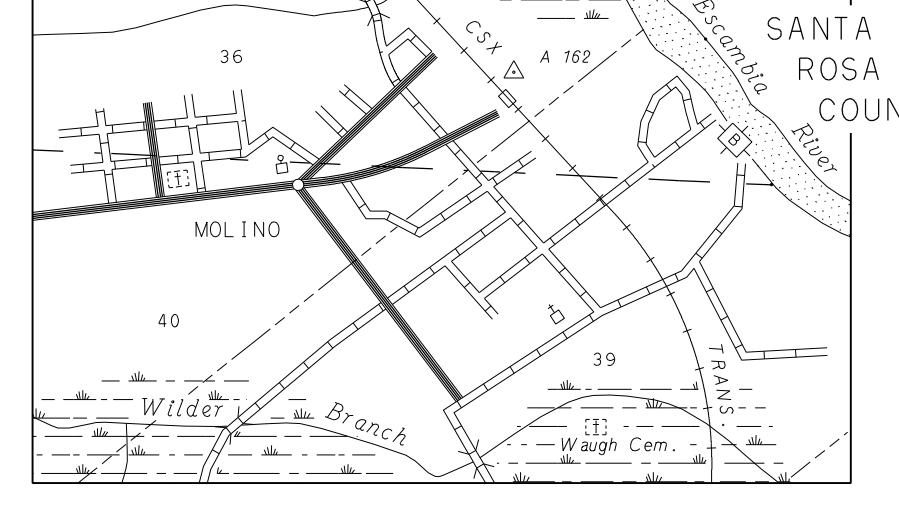

INSET "A"
T 2 N, T 3 N - R 31 W

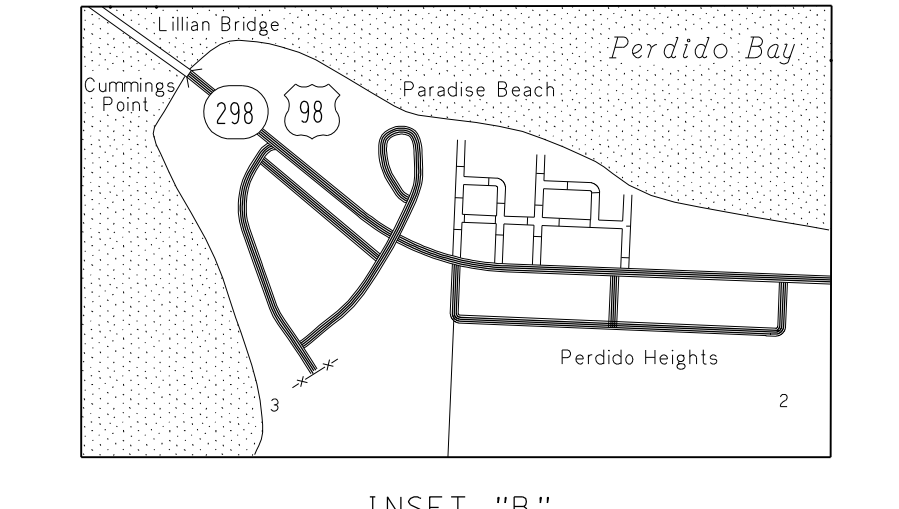

INSET "B"
T 2 S - R 32 W

This map was compiled from U.S. Geological Survey quadrangle maps, aerial photography flown in March, 1990, General Land Office maps, road inventory surveys June, 1998, and other map data.

This map was compiled using interactive computer graphic techniques.

This map was prepared on the Lambert conformal conic projection, 1983 North American Datum, North Zone, Florida system of plane coordinates.

The railroad station symbol as shown on this map does not necessarily denote the presence of a depot or live facility. It may be only a point designated for the receipt or delivery of freight, such as a platform or siding.

Local road segments in Delimited Areas and Residential Areas Under Development are not depicted.

In congested rural areas local roads are indicated by a single line only. For details refer to insets prepared for this county.

No attempt has been made to show all drainage canals and ditches.

Due to insufficient space land grants will not be identified by name on this county.

City populations are taken from the U. S. Census for 1990.

In 1990, the population of Escambia County was 262,798. There are 66 square miles in the county.

No claim is made for this basic cartographic source material taken from a work or works of the United States Government.

Most of this series are in the public domain. The maps are compiled and published using public law money and are copyrighted to prevent piracy and resale for profit.

Permission to copy or reproduce this map must be authorized by the Surveying and Mapping Office, Department of Transportation, Tallahassee, Florida 32399-0500.